

# Building Sketch

*MC*  
06/22/23  
2:11 PM EDT  
dotloop verified

*MC*  
06/22/23  
7:51 PM CDT  
dotloop verified

Borrower	Niles Corley				
Property Address	211 Walla Walla Ct				
City	Greenville	County	Greenville	State	SC
Lender/Client	NVR Mortgage Finance, Inc.				
				Zip Code	29607

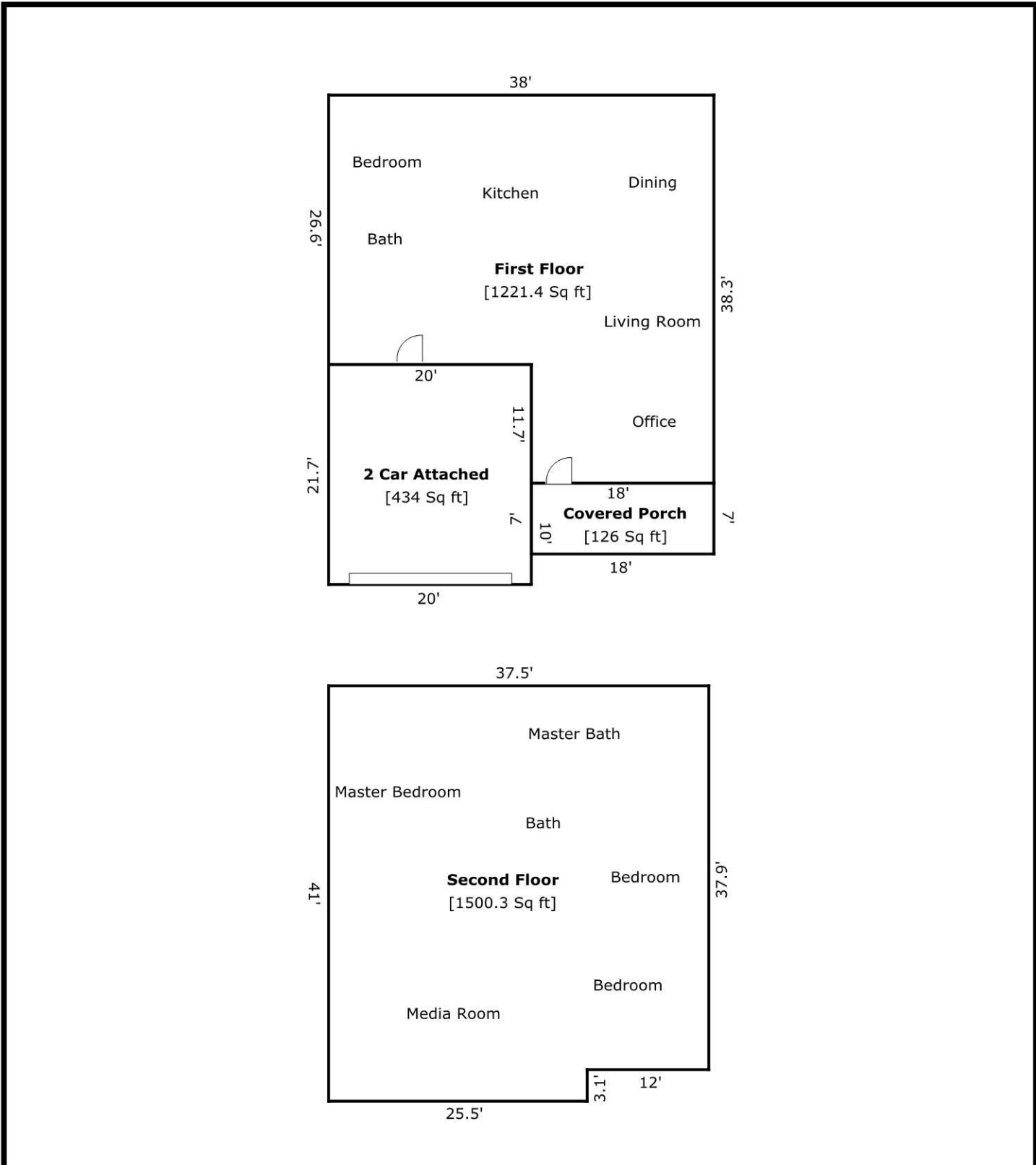

TOTAL Sketch by a la mode, inc.

### Area Calculations Summary

Living Area		Calculation Details
First Floor	1221.4 Sq ft	$26.6 \times 20 = 532$
		$18 \times 38.3 = 689.4$
Second Floor	1500.3 Sq ft	$37.5 \times 37.9 = 1421.25$
		$25.5 \times 3.1 = 79.05$
<b>Total Living Area (Rounded):</b>	<b>2722 Sq ft</b>	
<b>Non-living Area</b>		
Covered Porch	126 Sq ft	$18 \times 7 = 126$
2 Car Attached	434 Sq ft	$21.7 \times 20 = 434$