



Blue Ridge Rural Water Company

Notice: This electronic mail transmission and any attachment to it, has been scanned by an antivirus program, but in order to protect your system BRRWC recommends that you conduct an independent virus scan. All contents within this transmission are privileged and confidential information intended only for the personal and confidential use of recipient designated above. If you are not the intended recipient of this communication, or the employee or agent responsible for delivering it to the intended recipient, you are hereby notified that any review, disclosure, copying, distribution or use of the contents of this information is strictly prohibited. If you have received this communication in error, please immediately notify the sender and destroy the original message and all copies. BRRWC Thanks you.



Please consider the environment
before printing this e-mail.



From: Cindy Hosea <cindy@blackstreaminternational.com>
Sent: Monday, November 22, 2021 1:51 PM
To: Brad Powers <bpowers@brrwc.org>
Subject: Pittman Creek land



Onsite Wastewater System Application

Bureau of Environmental Health Services

Please use this space to sketch a drawing of the property.

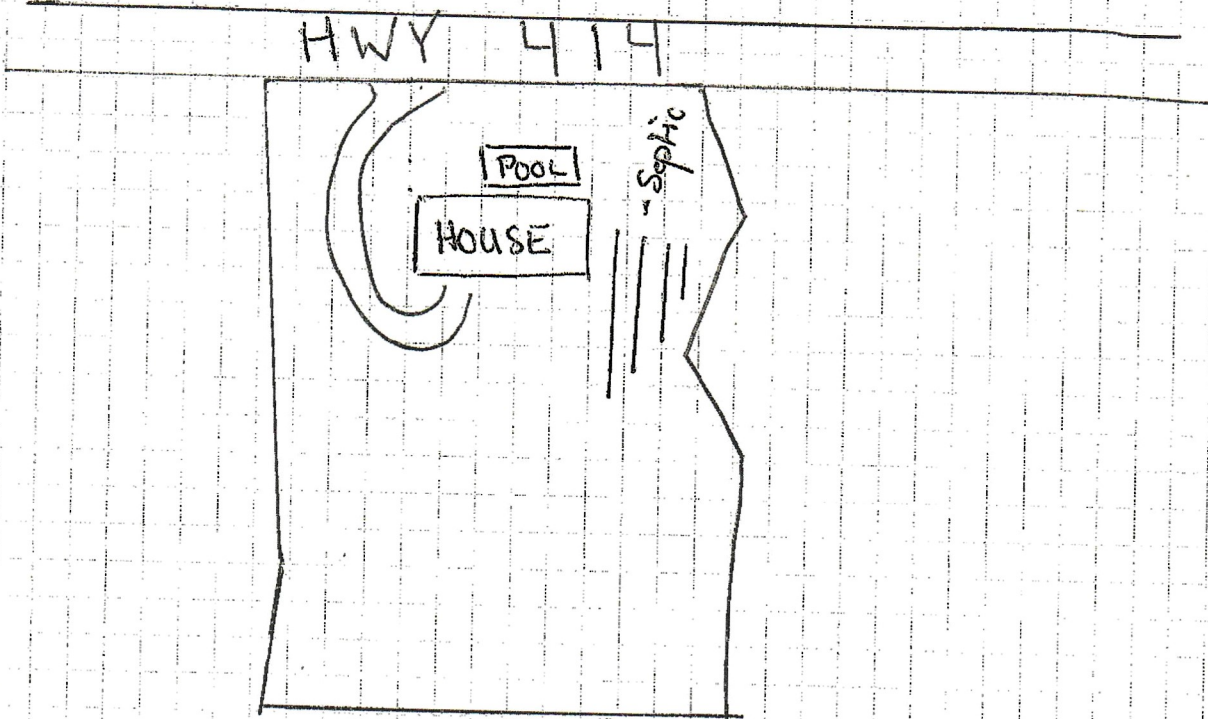

Does not need to be drawn to exact scale but should be legible and drawn clearly.

Check here if the sketch is attached on a separate sheet or on the plat instead of this application.

Sketch must include labelling the location, dimensions, and distance from property lines of existing and/or proposed:

- Primary building
- Septic tank and drain field area
- Wells, including those on adjacent properties
- Underground utility lines, existing drainage pipes, and/or easements
- Driveways, parking areas, or other vehicular traffic or traffic bearing structures
- Porches, decks, pools, garages, carports, out-buildings, and other permanent structures and their dimensions
- Areas of grading or other soil disturbance, changes in drainage patterns, or changes in surface or topographical features on the site

Please note that any changes such as grading, soil disturbances, or site alterations to topography could negatively impact the wastewater system or lead to permit revocation.

Churillo, Mike

From: Gibbon, Jonathan D. <gibbonjd@dhec.sc.gov>
Sent: Friday, January 14, 2022 1:05 PM
To: Churillo, Mike
Subject: [EXTERNAL] Septic Permit
Attachments: [Untitled] (41).pdf

Mike,

Attached is your septic permit on Pittman Creek in Taylors, SC.

Jon Gibbon
Environmental Health Manager
S.C. Dept. of Health & Environmental Control
Office: (864) 372-3155
Mobile: (864) 608-0692
Connect: www.scdhec.gov [Facebook](#) [Twitter](#)





APPROVAL TO OPERATE

Department Staff Inspection - Onsite Wastewater System

File Nbr: **2021120019**

County: **Greenville**

Name: MARK CHURILLO
Type Facility: HOUSE
Subdivision
Block: 4 BR

Address: 43299 MULBURY COVE WAY
AUBURN, GA 30011
Site: 4 PITTMAN CREEK
TAYLORS, SC

Program Code: 360
System Code:
TM No. 0644.01-01-014.04
Water Supply: PUBLIC

ACTUAL INSTALLATION

(NTS)

FINAL APPROVAL

Installer:

Septic Tank Mfg:

Pump Chbr Mfg:

Pump Mfg:

Pump Model:

Grease Trap Mfg:

Alternative Product:

Aggregate Type:

Aggregate Depth (in):

Trench Width (in):

Trench Depth (in):

Fill Cap:

Fill Cap Depth (in):

Well Installed:

Well Dist (ft):

Building Dist (ft):

Property Dist (ft):

Water Dist (ft):

Tank Size (gal):

Pump Chamber Size (gal):

Elevation Readings:

Plumbing Stubout:

Septic Tank Inlet:

Septic Tank Outlet:

Pump Chamber Inlet:

Line No.

_____	_____
_____	_____
_____	_____
_____	_____
_____	_____
_____	_____
_____	_____
_____	_____

Comments:

Licensed Installer

Printed Name _____ License No. _____

I hereby certify the system was installed in accordance with the referenced permit and R.61-56 and is in an exposed condition ready for inspection.

Licensed Installer Signature _____ Date _____

Office Use Only

APPROVAL BY DHEC TO OPERATE

THIS CERTIFICATE OF FINAL APPROVAL IN NO WAY GUARANTEES THE LIFE OF THE SYSTEM OR THAT IT WILL FUNCTION PROPERLY UNDER ANY OR ALL CONDITIONS

Approved By: _____ Date: _____



APPLICATION SUPPLEMENTAL FORM

Onsite Wastewater System

File Nbr: 2021120019

County: Greenville

Name: MARK CHURILLO

Address:

43299 MULBURY COVE WAY
AUBURN, GA 30011

Program Code: 360

Type Facility: HOUSE

System Code:

Subdivision

Site: 4 PITTMAN CREEK
TAYLORS, SC

TM No.: 0644.01-01-014.04

Block: 4 BR

Lot:

Water Supply: PUBLIC

ACTUAL INSTALLATION

House sits on Kroll

(NTS)

10 Acres

SIT = Septic Tank

R = Repair

L1 = 100'

L2 = 100'

L3 = 100'

L4 = 100'

L5 = 100' R

L6 = 100' R

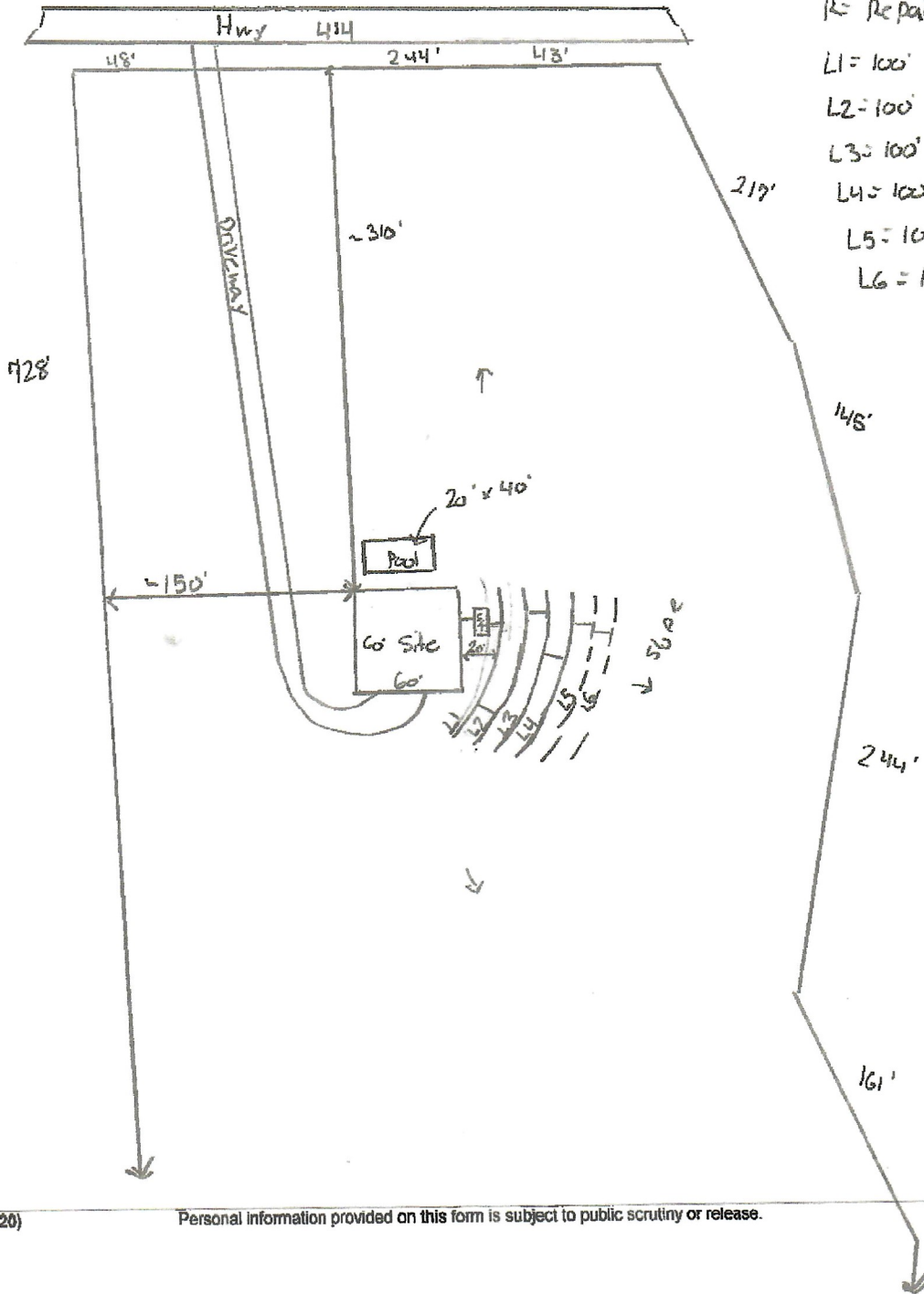



**PERMIT TO CONSTRUCT
Onsite Wastewater System**

File Nbr: **2021120019**
County: **Greenville**

Name: **MARK CHURILLO**

Type Facility: **HOUSE**

Subdivision:

Block: **4 BR**

Lot:

Address: **43299 MULBURY COVE WAY
AUBURN, GA 30011**

Site: **4 PITTMAN CREEK
TAYLORS, SC**

Program Code: **360**

System Code: **100**

TM No.: **0644.01-01-014.04**

Water Supply: **PUBLIC**

PERMIT TO CONSTRUCT SYSTEM SPECIFICATIONS

Daily Flow (gpd): **480**

Tank Sizes (gal): **Septic Tank: 1000**

Pump Chamber:

Grease Trap:

LTAR: **.40**

Trenches: Length (ft): **400**

Width (in): **36**

Max. Depth (in): **48**

Agg. Depth (in): **14**

Min Pump Capacity:

gpm at

ft. of head

Alternative Product:

SPECIAL INSTRUCTIONS/CONDITIONS

THIS PERMIT IS SITE SPECIFIC. ANY CHANGES TO THE SYSTEM MUST BE APPROVED BY DHEC. ALTERNATIVE TRENCH PRODUCTS APPROVED UNDER STATE RULES AND REGULATIONS MAY BE SUBSTITUTED. ANY UNAPPROVED CHANGES WILL VOID THIS PERMIT.

Installers must contact the local Environmental Affairs office by 10:00 AM on the day prior to installation in order to schedule a time for the final inspection.

If a Department representative does not arrive within 30 minutes of the scheduled time, the installer may conduct the final inspection.

When a contractor self-inspection occurs, the installer must complete the DHEC form 3978, Approval to Operate Contractor Self-Inspection.

The installer must submit DHEC form 3978 within 2 business days of the completion of the installation.

Maintain 15' off pool.

PERMIT TO CONSTRUCT SYSTEM DIAGRAM

(NTS)

See Attached Supplemental Form

Issued/Revised By: *[Signature]*

Date: *1/14/2022*

DHEC 1781 (02/2020)

This Permit is Appealable Under the Administrative Procedures Act.

This permit will expire and become null and void five (5) years from the issuance date.

There may be an Additional Fee for Changes in this Permit that Require a Site Reevaluation.

Personal information provided on this form is subject to public scrutiny or release.