

### Building Sketch (Page -1)

Borrower	Richard and Monica Remer				
Property Address	143 Heatherwood Ln				
City	Greer	County	Spartanburg	State	SC
Zip Code	29651				
Lender/Client	Homebridge Financial Services, Inc.				

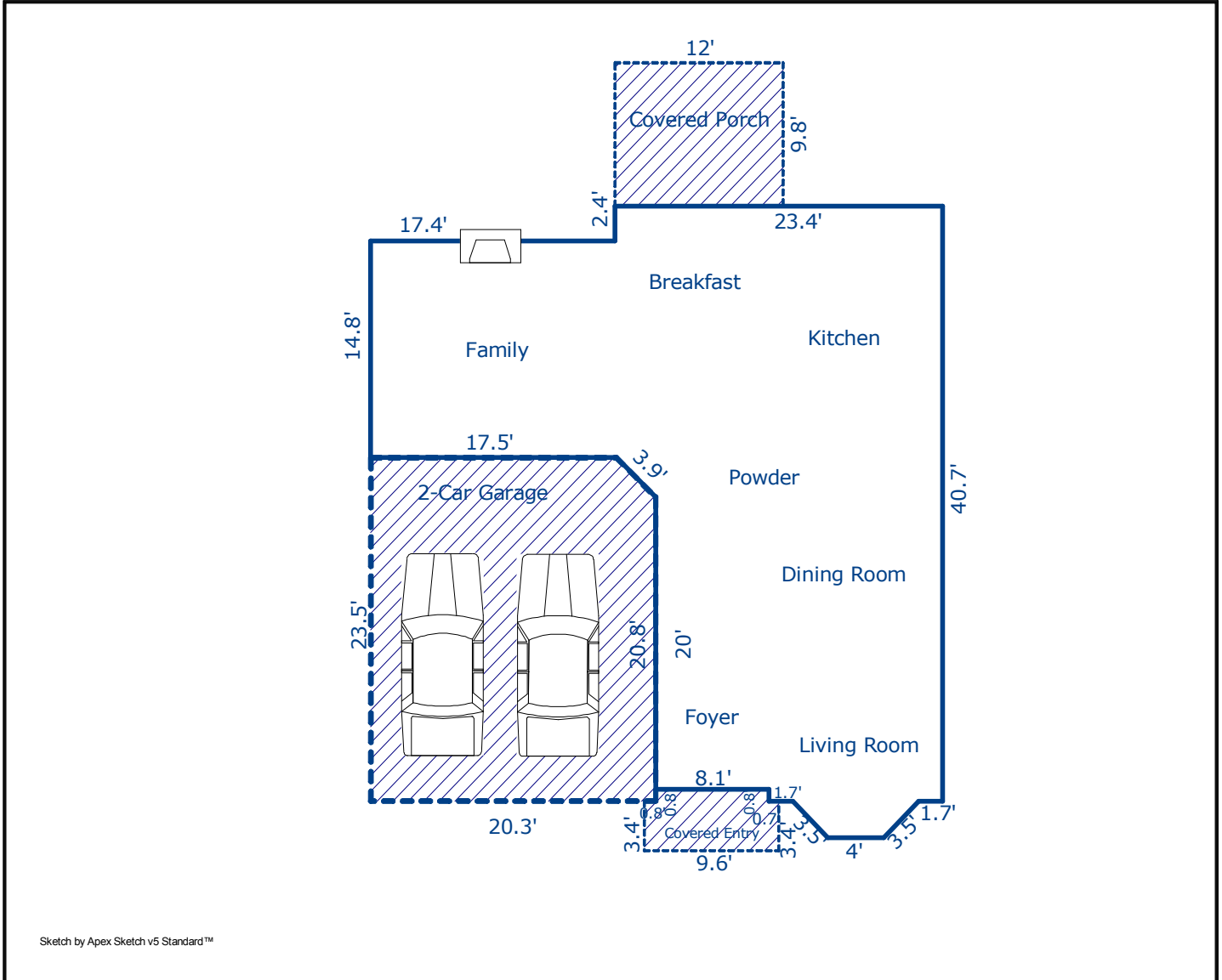

Comments:

AREA CALCULATIONS SUMMARY			
Code	Description	Net Size	Net Totals
GLA1	First Floor	1155.30	1155.30
GAR	2-Car Garage	473.27	473.27
P/P	Covered Porch	117.60	
	Covered Entry	39.12	156.72
Net LIVABLE Area		(rounded)	1155

LIVING AREA BREAKDOWN			
Breakdown		Subtotals	
First Floor			
20.5 x	22.7		465.35
0.8 x	12.4		9.92
2.4 x	23.4		56.16
14.8 x	40.8		603.84
0.5 x	2.5 x	2.5	3.13
0.5 x	2.8 x	2.7	3.78
	4.0 x	2.5	10.00
0.5 x	2.5 x	2.5	3.13
8 Items		(rounded)	1155

### Building Sketch (Page - 2)

Borrower	Richard and Monica Remer				
Property Address	143 Heatherwood Ln				
City	Greer	County	Spartanburg	State	SC
				Zip Code	29651
Lender/Client	Homebridge Financial Services, Inc.				

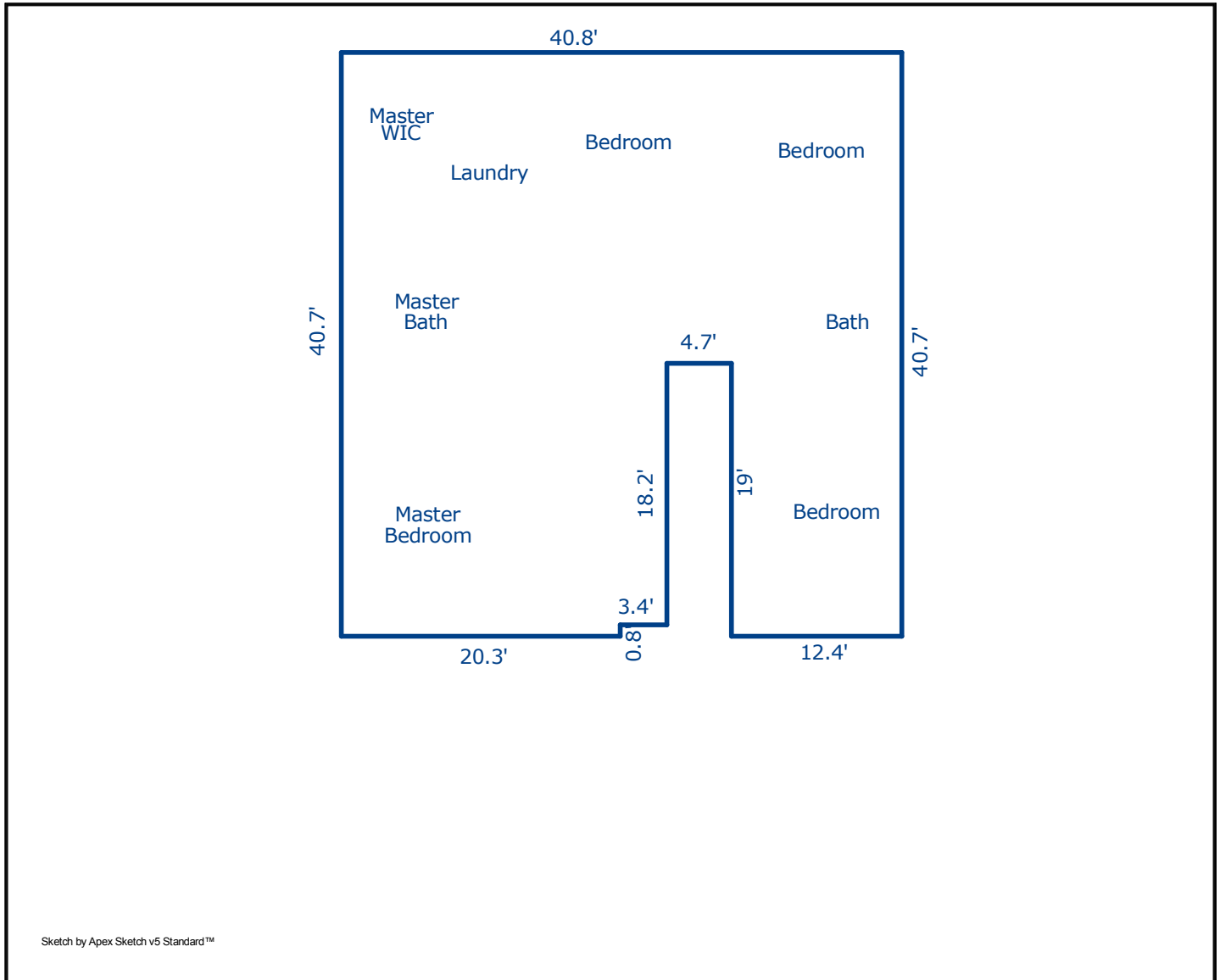

Comments:

AREA CALCULATIONS SUMMARY			
Code	Description	Net Size	Net Totals
GLA2	Second Floor	1568.54	1568.54
Net LIVABLE Area		(rounded)	1569

LIVING AREA BREAKDOWN			
Breakdown		Subtotals	
Second Floor			
19.0	x	12.4	235.60
0.8	x	20.3	16.24
18.2	x	23.7	431.34
21.7	x	40.8	885.36
4 Items		(rounded)	1569