

## SKETCH ADDENDUM

|                  |                                      |          |          |
|------------------|--------------------------------------|----------|----------|
| Intended User    | Beth Barkley/Robert & Melissa Griggs |          |          |
| Property Address | 106 Melissa Ct                       |          |          |
| City             | Piedmont                             | County   | Anderson |
|                  |                                      | State    | SC       |
|                  |                                      | Zip Code | 29673    |
| Client           | Beth Barkley                         |          |          |

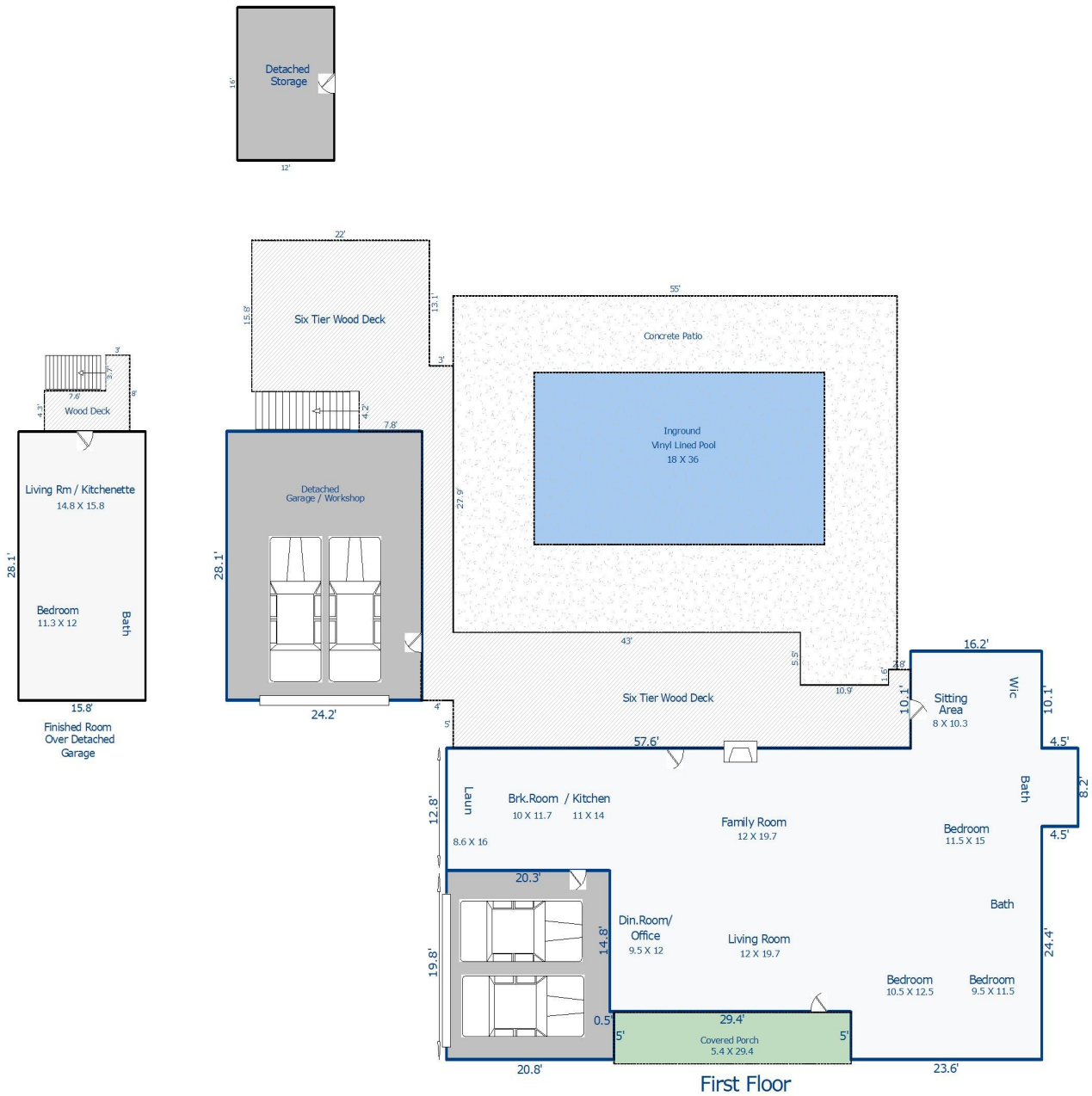

Sketch by Apex Sketch v6 Standard™

Comments:

| AREA CALCULATIONS SUMMARY |                     |           |             |
|---------------------------|---------------------|-----------|-------------|
| Code                      | Description         | Net Size  | Net Totals  |
| GLA1                      | First Floor         | 2054.96   | 2054.96     |
| GAR                       | Two Car Garage      | 404.44    |             |
|                           | Det. Garage/Wkshop  | 680.02    | 1084.46     |
| P/P                       | Covered Porch       | 158.76    |             |
|                           | Six Tier Wood Deck  | 1131.03   |             |
|                           | Concrete Patio      | 2000.24   |             |
|                           | Inground Pool       | 648.00    |             |
|                           | Wood Deck           | 56.68     | 3994.71     |
| OTH                       | Fin. Room Over Gar. | 443.98    |             |
|                           | Detached Storage    | 192.00    | 635.98      |
| <b>Net LIVABLE Area</b>   |                     | (rounded) | <b>2055</b> |

| LIVING AREA BREAKDOWN |   |      |                       |
|-----------------------|---|------|-----------------------|
| Breakdown             |   |      | Subtotals             |
| <b>First Floor</b>    |   |      |                       |
| 73.8                  | x | 4.6  | 339.48                |
| 14.8                  | x | 53.5 | 791.80                |
| 78.3                  | x | 8.2  | 642.06                |
| 5.0                   | x | 23.6 | 118.00                |
| 10.1                  | x | 16.2 | 163.62                |
| <b>5 Items</b>        |   |      | (rounded) <b>2055</b> |